

Templeton Student Center

Project Assumptions or “Givens”

Not changing:

- Bathrooms, Elevators and Mechanical
- First Floor – Health Services, Cashier, Service areas
- Second Floor – Book Store, Council Chamber, ½ of existing computer lab

Not likely to change:

- First Floor – Registrar
- Second Floor – Mail Room
- Third Floor – Kitchen will not expand

Design issues for Study:

- Building program
 - Verify Givens and Goals
 - Verify Program
 - Assess Existing conditions
- Food Service – space allocation
- Entry design – Multiple Main Entries
- Circulation Design
- First Floor -
 - Financial Services Move
 - Services Area
- Second Floor-
 - Student Meeting Rooms
 - Student Offices
 - Student Lounge/Co-op
 - Computer Lab
 - Mail Room
 - Trail Room Food Service Café (?)
- Third Floor -
 - Rework or Consolidation of Food Services
 - Registration Table Area
 - Bon Appetite Offices
 - Thayer Lounge
 - Cafeteria
 - Student Offices or Lounge

- Not changing
- Not likely to change



first floor



second floor

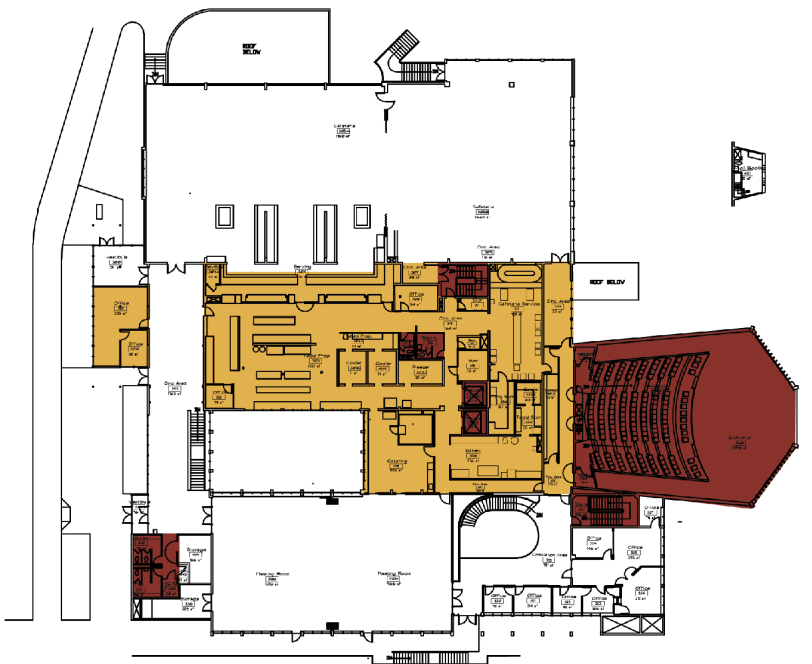

third floor